

Thank you for purchasing our unique designed hand-quilting quilt frame system. Vonda's family has been dedicated to creating an easier way to hand-quilt for over 30 years. We are proud that you have chosen our quilt frames to tell your story, give a gift, gather 'round, or to simply keep yourself warm.

Every quilt has a story and we'd love to be part of yours. Time to begin.

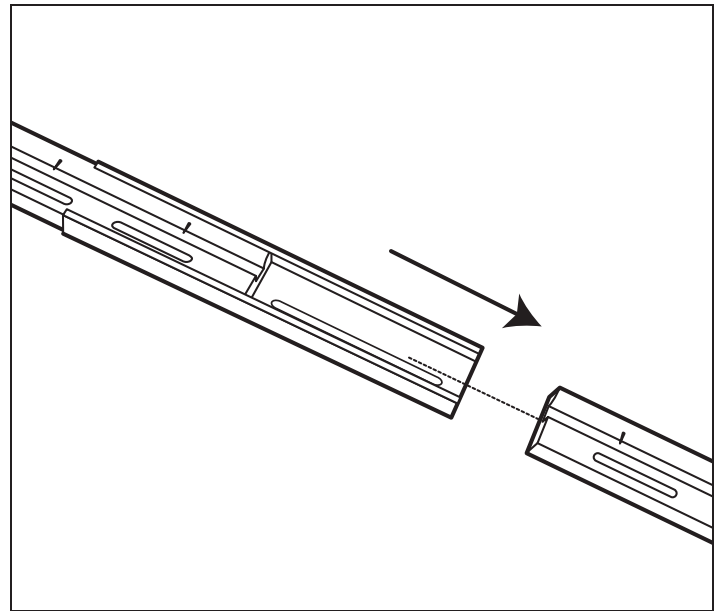
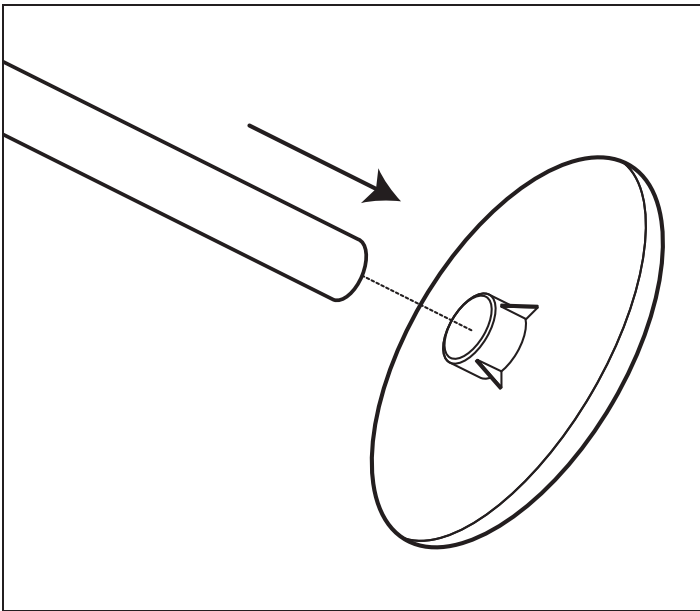

Please check the box for the following contents:

- 12-4 ft. Wooden Slats with Recessed Nails
 - 2-2 ft. Wooden Half Slats
 - 8-Metal Extension Sleeves
 - 4-Legs & Foot Plates
 - 4-Washers & Wing nuts
-



1 Determine your quilt size. Then, insert the four white legs into the four circular plates. (See Set-up Size Guide on back page)

2 Assemble wood slats to length needed for quilt. Slide wood slats into metal sleeves.

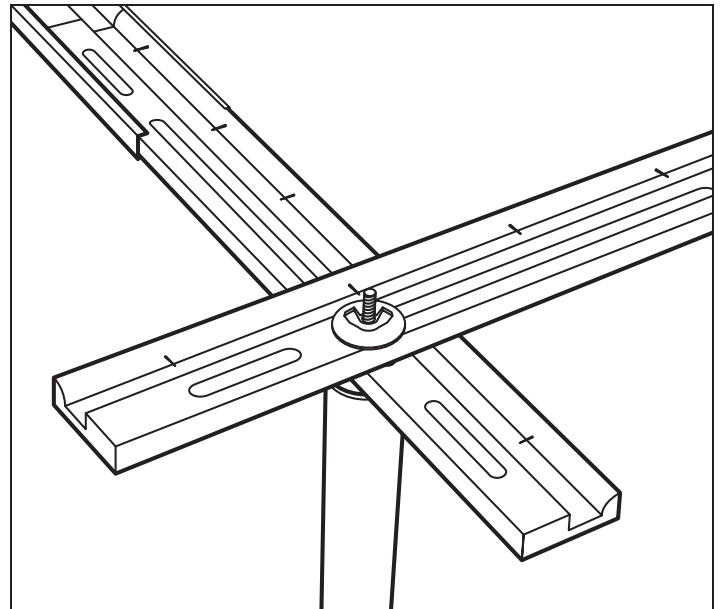
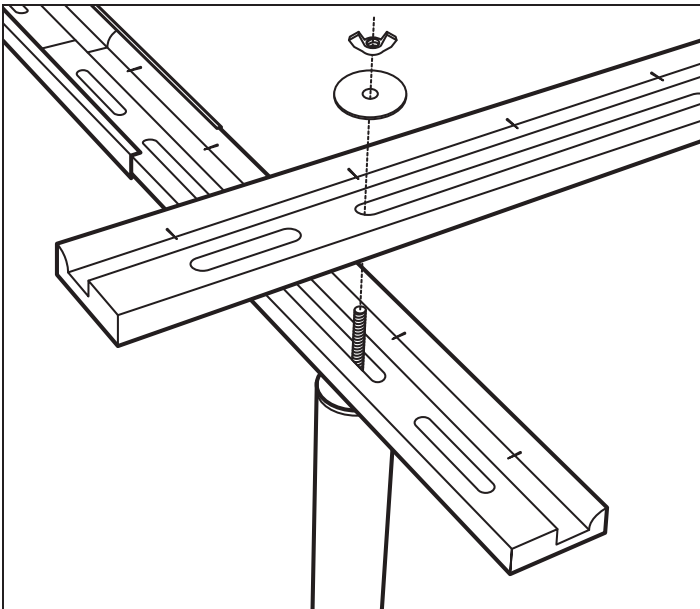

3 Remove wing nuts and washers from each leg prior to assembling. Place assembled wood lengths over leg bolts on parallel sides. Layer perpendicular slats over the leg bolt. The nails on the slats should be pointing outward.

4 Replace washers and wing nuts on the top of each bolt through the slats. Tighten wing nuts at each corner to secure legs. Square the quilt.

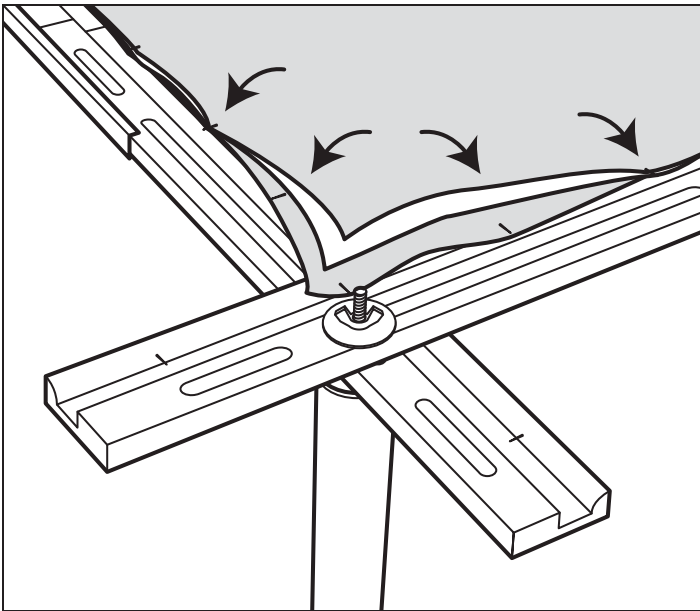

- 5 Attach all three layers onto frame one layer at a time. First, pull quilt back material over the nails. Spread batting onto the backing material. Lay quilt top fabric over the batting, and pull over the nails.

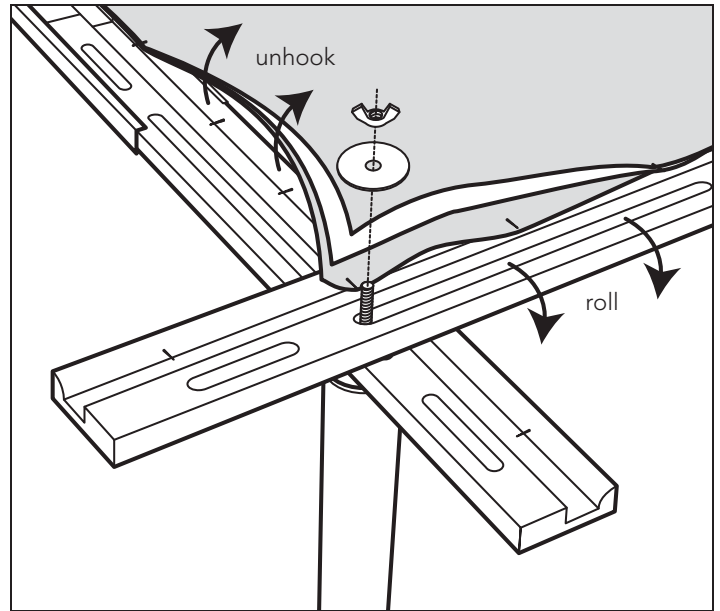

- 6 When ready to roll, unhook the fabric from the nails equal to the distance you want to roll on both sides. Remove the wing nut and washer from the side you wish to roll.

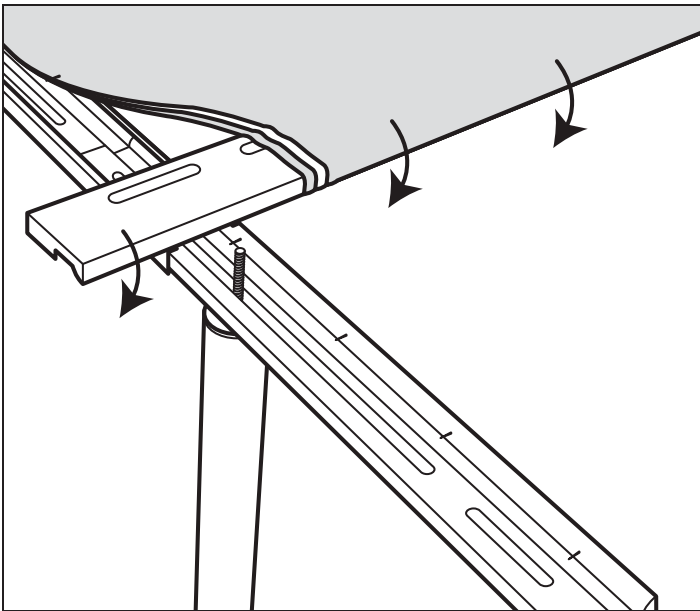

- 7 With another person, remove the top slat from corner bolts; keeping quilt fabric taut while lifted. Roll quilted portion around the slat. Return slat over bolt. Slide to tighten.

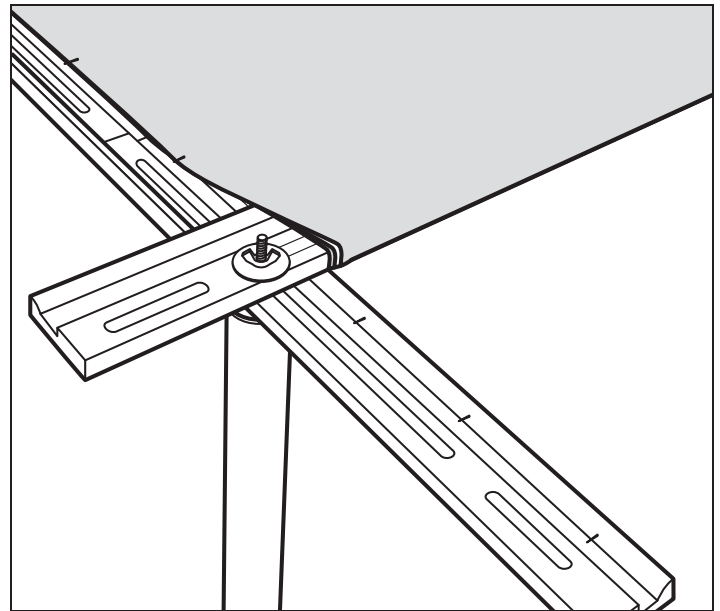

- 8 Refasten washers and wing nuts to secure slat. Keep fabric clear between joining boards for strongest hold. Wood on wood is preferred and most secure. Repeat rolling procedure until completed.

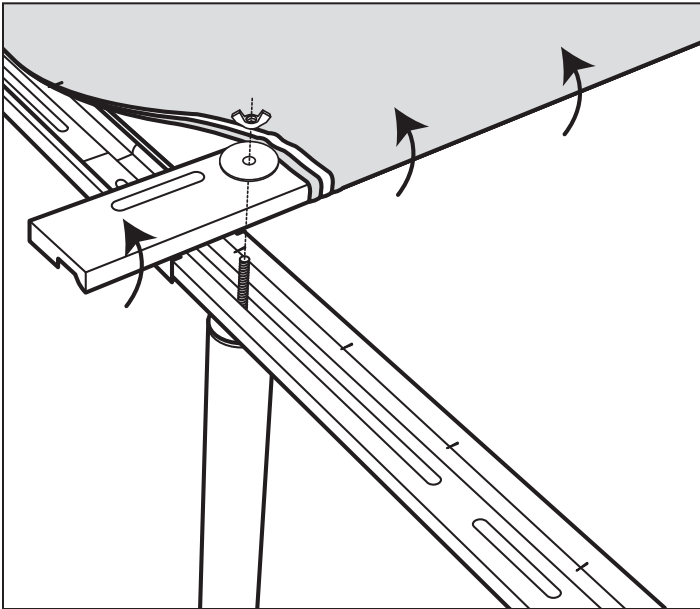

- 9 Release the quilt from the slats by removing the washers and wing nuts from the slats holding the rolled fabric. Reverse the rolling procedure until the quilt falls off! The remaining fabric sides and end that may still be attached to the frame can simply be lifted off the nails. Bind quilt as needed.